

Data sheet - Support roller STO 45TN (crowned, with inner ring)

Designation	STO 45
Type	crowned
D [mm]	85
d [mm]	45
F, Fw * [mm max.]	55
B1 [mm]	20
B [mm]	19,8
d1 [mm]	63
r [mm]	1
Dynamic load Crw [N]	25500
Static load C0rw [N]	43000
Speed limit [min-1]	1500

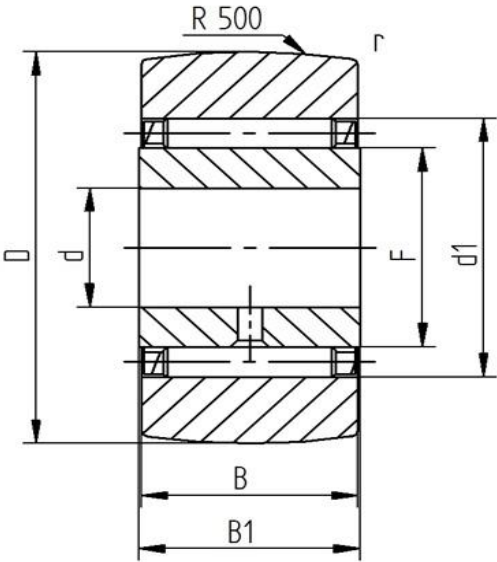

Every specification has been edited and verified carefully. STI Bearings GmbH assumes no liability for potential errors or incompleteness. Technical modifications are subject of changes.  
© 2020 by STI Bearings GmbH  
Reproduction, even excerpts, only with our approval.